

Boundary Connections II Forest Legacy Project



2017 Forest Legacy - Boundary Connections II



2017 Forest Landowners

- Small Pvt (277 Acres)
- Molpus (611 Acres)
- Hancock (1456 Acres)
- Existing Conservation Easement

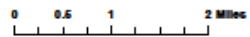
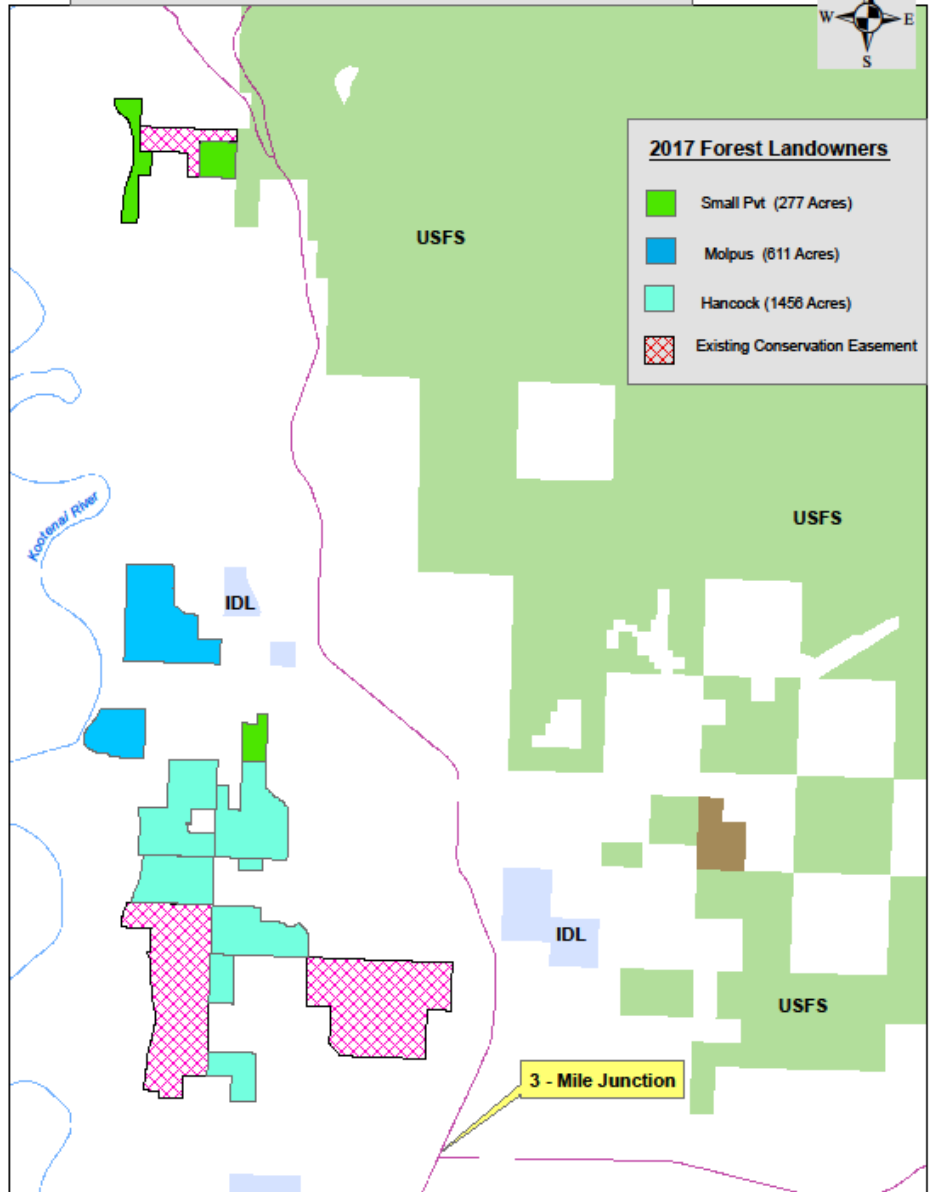

KM May, 13, 2017

2017 Forest Legacy - Boundary Connections II

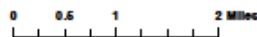
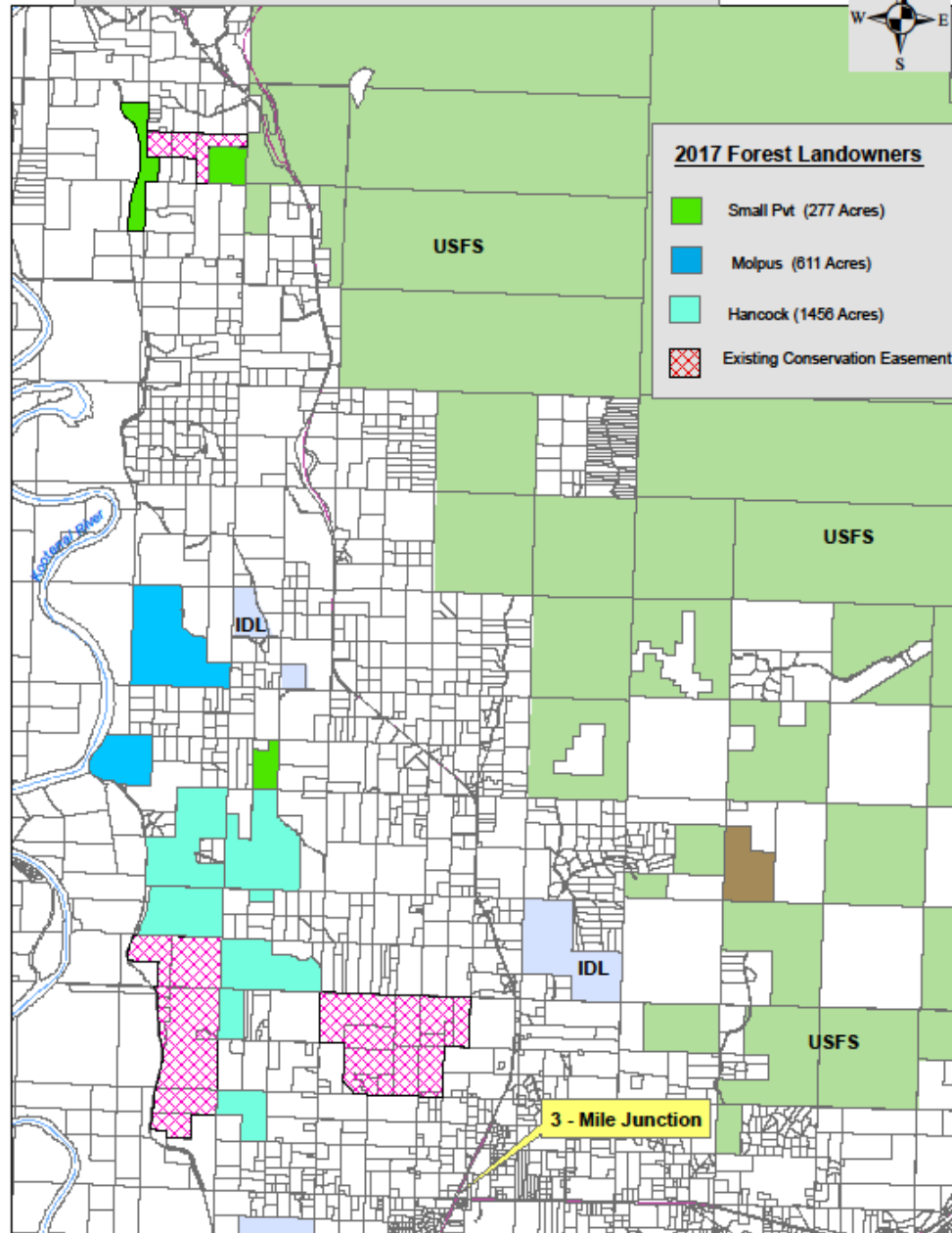

Boundary Connections II Forest Legacy Project

Forest Legacy Program -- a voluntary program that protects important private forestlands that are threatened by conversion to non-forest uses; the intent of this program is to protect our rural “working resource lands” for the benefit of our local & regional resource-based economies.

- 1) Idaho Dept of Lands (IDL) sponsored program. Funds come from the Land & Water Conservation Fund (Federal Farm Bill) which originates from federal oil and gas leases.
- 2) Conservation easement restricts **subdivision** and major **development**.
- 3) All **traditional uses are permitted** (Agriculture, Forestry, Livestock, cottage industries, rentals, gravel pits, etc)
- 4) Home/shops/ barns/outbuildings are permitted on each parcel if the owner desires.
- 5) Property taxes do not change. Yield taxes do not change.
- 6) Conservation easement is perpetual.

Boundary Connections II Forest Legacy Project

- **2343 acres** of forestland in this project.
 - 2,067 acres are industrial forestland (88% of acres) (Molpus & Hancock)
 - Three family woodlands (276 acres) (12%)
- **70% of the acres** are in healthy, vigorous **plantations** (WL, DF, & WWP) from 10 – 25 years of age. Plantations are managed for 40 year rotations.
- These are **very productive forestlands**. Most of these lands have been well managed over the past 30 years by Crown Pacific, Forest Capital, and now Molpus & Hancock.
- This area is used heavily by **elk for spring calving**.
- **Three grizzly bears** have been documented on these properties over the past 25 years.
- **Adjacent Conservation Easements** – This project will add to and complement three prior Forest Legacy projects:
 - Bane Creek FLP – FY2010: 720 acres,
 - Boundary Conn FLP – FY2012: 750 acres,
 - Selkirk – KV FLP – FY2016: 150 acres
- This project in conjunction with these 3 other Forest Legacy projects mentioned above will protect these **water resources**:
 - Kootenai River frontage – 2,150' (one side only) (Class I)
 - Bane Creek -- 22,340' on both sides (Class II)
 - Fleming Creek – 7,940' on both sides (Class II)
 - N. Fk Fleming Crk - 4,330' on both sides (Class II)
 - Brush Creek – 7,150 on both sides (Class II)
 - NB 17 unnamed Crk – 7,790 on both sides (Class II)
- Hancock and Molpus will provide for **Public Access** for their forestlands in this project (2,067 Acres).

Idaho Forest Products Industry

- Annual Mill Consumption in Timber: 1 billion board feet of logs → 222,200 log truck loads.
- 2) 60% - 65% of this timber → grown & harvested on Private forestlands → 625 million board feet → 138,000 log truck loads (average for past 20+ years).
- 3) 30% - 35% of this timber → from IDL forest lands
- 4) Less than 10% of the harvest is from USFS lands
- 5) Moyie Mill -- consumes 80 – 85 mmbf of logs annually (19,000 log truck loads)